



SUPPORT EXTENSIONS

Description

Manufactured in France, the Easyfix extension provides the option of adding additional space between the insulation and the metal rail. It is unique in the market.

Products Features

- Easy Attachment: It attaches easily to existing supports, enabling the addition of extra space between the insulation and the metal rail.
- **Availables in 2 sizes :**
 - 100 mm
 - 150 mm

Informations

Réf	Designation	Building type	Height (mm)	Pack	Dimensions	Weight (KG)	Pack / Pallet	Public Price (Excl.VAT)	EAN Code
03040	Suspente Rallonge Easyfix 100	Rénovation/neuf	0-100	50 pcs.	230 x 230 x 160	1.530	150	64.90€	3760324607176
03041	Suspente Rallonge Easyfix 150	Rénovation/neuf	0-150	50 pcs.	370 x 220 x 160	2.000	150	69.90	3760324607237

INTERMEDIARY SUPPORT EXTENSION



► Products Features

Available in two lengths, 100 mm and 150 mm, our extensions easily attach to EASYFIX intermediate supports and metal rails. Ideal for creating technical spaces, they ensure quick and efficient installation.

- Integrates all types of networks and lighting spots while providing effective protection between the membrane and the facing.

Applications

Advantages :

- Compatible with all types of rails.
- Quick installation : no additional adjustments required
- Reduce thermal bridging
- Removable system

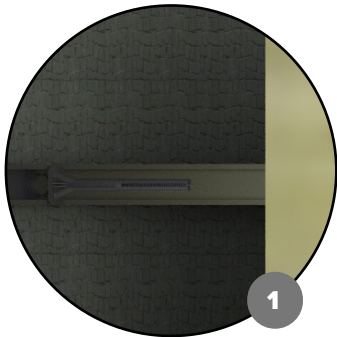

1

1. Attach the support
2. Install the insulation



2

3. Clip the joint
4. Install the Membrane

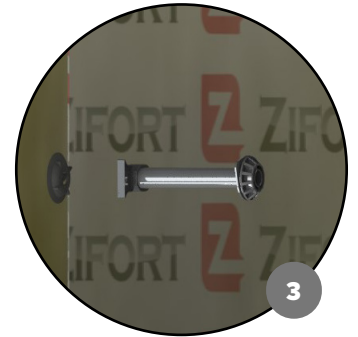

3

5. Positions the RT Easyfix washer
6. Position the extension
7. Fit the extension

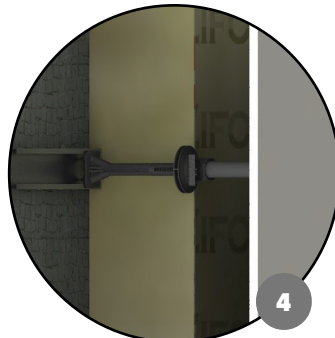

4

Final



Watch the videos

